



AIRPORT EXECUTIVE CENTER

155 PASSAIC AVENUE, FAIRFIELD, NEW JERSEY



AIRPORT EXECUTIVE CENTER

155 PASSAIC AVENUE, FAIRFIELD, NEW JERSEY

Building Features and Amenities:

- A four-story, Atrium Building comprising 88,000 square feet
- Full height sky-lit atrium with high quality finishes
- Recently renovated lobby and public areas
- Fiber optics and other high speed telecommunication options
- 24-hour keypad access
- Fully sprinklered and alarmed
- On-site Building Manager
- Professional Local Ownership & Management

Location Features:

- Just off Route 46 offering convenient access to Route 23, I-80, I-287 & Route 280
- Adjacent to the Essex County Airport (aka Caldwell Airport)
- Walking distance to restaurants and banking facilities
- Nearby hotels, retail shops and The Willowbrook Mall

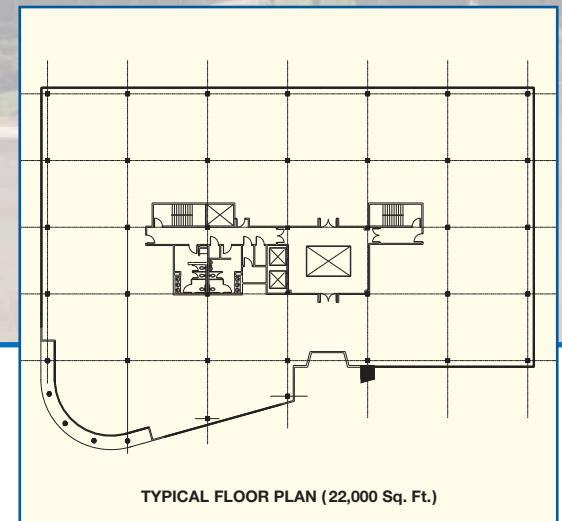

For leasing information please contact:

John G. Osborne, Director of Leasing (ext. 115)
Isabel Freire, Assistant Director of Leasing (ext. 120)

732.855.8600

www.bergmanrealty.com

