



## **510 AT METROPARK**

510 THORNALL STREET, EDISON, NEW JERSEY



*Owners/Managers*

# 510 THORNALL STREET EDISON, NEW JERSEY

## Building Features & Amenities:

- A 3-story Office Building comprising 65,000 square feet
- Efficient design offers large number of corner offices
- Two levels of partially covered parking
- 24-hour card key access
- Fiber optic and other high speed telecommunications options
- On-Site Building Manager
- Professional local Ownership and Management

## Location Features:

- Directly across from MetroPark Train Station (Amtrak and NJ Transit)
- Excellent access to the Garden State Parkway (Exit 131), the NJ Turnpike (I-95), Routes 1, 9, 27 and I-287
- Princeton Junction and Downtown Newark are within 15 minutes and NYC's Penn Station is within 30 minutes by rail
- Close proximity to the Woodbridge Hilton and Sheraton Hotels, Woodbridge Center and Menlo Park Shopping Malls

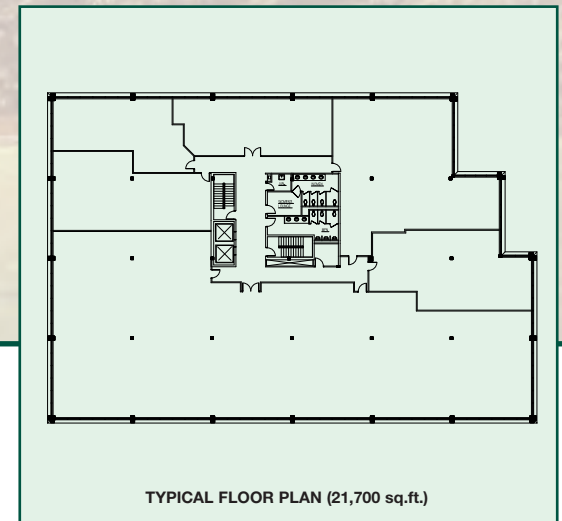

For leasing information please contact:

John G. Osborne, Director of Leasing (ext. 115)  
Isabel Freire, Assistant Assistant Director of Leasing (ext. 120)

**732.855.8600**

[www.bergmanrealty.com](http://www.bergmanrealty.com)



Owners/Managers

